



Joe Doud Administration Building
545 Academy Drive
Northbrook, IL 60062
847-291-2960
nbparks.org

January 10, 2023

ADDENDUM #1

Northbrook Park District

Heritage Oaks Golf Club: Golf Car Corral Fencing

Bid #2244

This addendum becomes part of and modifies, amends, and clarifies Project Manual for the above mentioned Bid. All provisions and requirements of the Project Manual shall remain in effect except as specifically changed in this addendum. Below is the list of revised items in Addendum #1.

Clarifications:

QUESTION: The bid form calls out Montage Commercial, yet the written specifications are for Montage II - Heavy Commercial. Can you let me know which product you are looking for?

ANSWER: The bid form calls for Montage Commercial Genesis, it should read Montage Plus Genesis. The updated bid form and updated specifications are attached to this Addendum.

Receipt of this addendum shall be acknowledged by signing below and including a copy within the Bid Documents.

Signature _____

Title

Company _____

Date _____

UPDATED: BID FORM 1/10/2023
Bid #2244 - Heritage Oaks Golf Club: Golf Car Corral Fencing

Proposal of _____,

Hereinafter called "Bidder", (a)/(an)_____ (corporation, partnership, individual)

doing business as _____

to the Northbrook Park District, hereinafter called "Owner."

Bidder acknowledges receipt of the following Addenda, which are a part of the Contract Documents:
Addenda Numbers: _____, _____, _____, _____, _____, _____.

By submission of his bid, the Bidder acknowledges, agrees, represents, declares and warrants:

- I. That he has visited and examined the site and is fully familiar with and has satisfied himself as to the site and the local and other conditions under which the Work is to be performed, including without limitation, (i) surface conditions of the site and subsurface conditions readily observable or ascertainable upon the exercise of reasonable diligence and all structures and obstructions thereon and thereunder, both natural and manmade; (ii) the nature, location and character of the general area in which the Project is located, including without limitation, its climatic conditions, available labor supply and labor costs, and available equipment supply and equipment costs; and (iii) the quality and quantity of all materials, supplies, tools, equipment, labor and professional services necessary to complete the Work in the manner and within the cost and timeframe indicated by the Contract Documents; and has correlated the Bidder's personal observations with the requirements of and matters indicated in or by the proposed Contract Documents.
- II. To hold the bid open for sixty (60) days subsequent to the date of the bid opening.
- III. To enter into and execute a Contract with the Owner within ten (10) days after the date of the Notice of Award, if awarded on the basis of this bid, and in connection therewith to:
 - a. Furnish all insurance required by the Contract Documents;
 - b. Accomplish the Work in accordance with the Contract Documents; and
 - c. Complete the Work within the time requirements as set forth in the Contract Documents.
- IV. That the Bidder has carefully examined the Instructions to Bidders, the Drawings and Specifications, and the Project Manual in its entirety, in order to determine how these affect the bid proposal, the forms of the Contract, the required Contract bonds, and duration thereof; and that the Bidder has inspected in detail the site of the proposed Work and been familiarized with all of the requirements of construction and of the governing municipalities under whose jurisdiction the Project falls (its codes, ordinances and construction requirements therein) and

understands that in making this proposal, the Bidder waives all rights to plead any misunderstanding regarding the same.

- V. That if this proposal is accepted, the Bidder is to provide all of the necessary equipment, tools, apparatus, labor, and other means of construction, and to do all of the Work and to furnish all of the materials specified in the Contract Documents in the manner and at the time therein prescribed, and in accordance with the requirements set forth.
- VI. To furnish Bid Bond in accordance with the Instructions to Bidders.
- VII. To furnish Performance/Labor and Material Payment Bond in accordance with the Instructions to Bidders.
- VIII. To commence work as specified in the Instructions to Bidders and to prosecute the Work in such a manner and with sufficient materials, equipment and labor as will ensure its completion within reasonable time, it being understood and agreed that the completion within such reasonable time is an essential part of this Contract.
- IX. To give the total base bid amount, the total add alternate and/or subtract alternate amounts (if requested) both in words and in figures. The total bid amount in each case shall be the sum of all of the total item amounts as applicable and as described above.
- X. That he has checked carefully the bid figures and understands that he shall be responsible for any errors or omissions based on these Specifications and alternates as submitted on the Bid Proposal Form.
- XI. That any and all prices stated in the proposal include all costs of labor, materials, equipment, insurance, bonds, overhead and profit, and any and all other costs normal to doing business.
- XII. That it is understood and agreed that the Northbrook Park District reserves the right to waive any technicalities and to accept or reject any or all bids, or to combine or separate any section or work, or to award to one Bidder for the entire Project or to any combination of Bidders for any portion(s) of the Project.

Bidders are responsible for verifying their own quantities. This worksheet is for use in calculating the lump sum amount. Contractor is required to alert Park District of any discrepancies prior to bidding the work. Failure to recognize the required quantities to complete the work shall be at the expense of the contractor. No consideration shall be given for additional compensation after the letting of bids.

Bidder agrees to perform all of the Work described in the Contract Documents for the following price:

BASE BID	LUMP SUM
HOGC CART CORRAL FENCE & GATES – using Montage Plus Genesis	
BASE BID TOTAL	

ADD ALTERNATE #1	ADDITIONAL COST
HOGC CART CORRAL FENCE & GATES – upgrade to Montage II Genesis	
ADD ALTERNATE #1 TOTAL	

Basic Unit Pricing List

4' tall Montage Plus Genesis Fencing (per linear foot) \$ _____

4' tall Montage II Genesis Fencing (per linear foot) \$ _____

2 ½" square 12 gage line posts set in concrete footings (per each) \$ _____

4" square 11 gage gate posts set in concrete footings (per each) \$ _____

PROJECT SCOPE

Unless otherwise indicated, the use of brand names in the following Specifications are used for the purpose of establishing a grade or quality.

***Bidders proposing to use an alternate that is equal to or superior to that required by the Specifications must request approval in writing to the Park District in accordance with Section X of the Instruction to Bidders.**

BASE BID

Furnish and Install:

- Roughly 325LF of 4' tall Montage Plus Genesis Fencing (or approved equal, see note above)
- 2 ½" square 12 gage line posts set in concrete footings
- 4" square 11 gage gate posts set in concrete footings
- One 4ft tall 10-12ft wide opening Transport II Cantilever Slide Gate (or approved equal, see note above)
- One 4ft tall 8-10ft wide opening Transport II Cantilever Slide Gate (or approved equal, see note above)
- All material to be powder coated black
- All other and incidental work necessary to complete the work as outlined in the contract documents.

*Plan dimensions are approximate and can be adjusted slightly to accommodate standard sizing. Fence and gates should be about 1' off the existing concrete pad.

ADD ALTERNATE #1: Upgrade to Montage II Genesis

END OF SECTION

AMERISTAR® PERIMETER SECURITY USA INC.
Montage Plus® - Steel Ornamental Fence System – Fusion Welded and Rackable
CONSTRUCTION SPECIFICATION - SECTION 32 31 19

PART 1 - GENERAL

1.01 WORK INCLUDED

The contractor shall provide all labor, materials and appurtenances necessary for installation of the welded ornamental steel fence system defined herein at Heritage Oaks Golf Club.

1.02 RELATED WORK

Section ____ - Earthwork

Section ____ - Concrete

1.03 SYSTEM DESCRIPTION

The manufacturer shall supply a total fence system of (specify Montage Plus® standard picket space) *Welded and Rackable* (ATF – All Terrain Flexibility) Ornamental Steel (for standard picket space Genesis™) design. The system shall include all components (i.e., panels, posts, gates and hardware) required.

1.04 QUALITY ASSURANCE

The contractor shall provide laborers and supervisors who are thoroughly familiar with the type of construction involved and materials and techniques specified.

1.05 REFERENCES

- ASTM A653/A653M - Standard Specification for Steel Sheet, Zinc-Coated (Galvanized) or Zinc-Iron Alloy Coated (Galvannealed) by the Hot-Dip Process.
- ASTM B117 - Practice for Operating Salt-Spray (Fog) Apparatus.
- ASTM D523 - Test Method for Specular Gloss
- ASTM D714 - Test Method for Evaluating Degree of Blistering in Paint.
- ASTM D822 - Practice for Conducting Tests on Paint and Related Coatings and Materials using Filtered Open-Flame Carbon-Arc Light and Water Exposure Apparatus.
- ASTM D1654 - Test Method for Evaluation of Painted or Coated Specimens Subjected to Corrosive Environments.
- ASTM D2244 - Test Method for Calculation of Color Differences from Instrumentally Measured Color Coordinates.
- ASTM D2794 - Test Method for Resistance of Organic Coatings to the Effects of Rapid Deformation (Impact).
- ASTM D3359 - Test Method for Measuring Adhesion by Tape Test.
- ASTM F2408 – Ornamental Fences Employing Galvanized Steel Tubular Pickets.
- IBC 2018 1607.8.1 Handrails and Guards

1.06 SUBMITTAL

The manufacturer's literature shall be submitted prior to installation.

1.07 PRODUCT HANDLING AND STORAGE

Upon receipt at the job site, all materials shall be checked to ensure that no damage occurred during shipping or handling. Materials shall be stored in such a manner to ensure proper ventilation and drainage, and to protect against damage, weather, vandalism and theft.

1.08 PRODUCT WARRANTY

A. All structural fence components (i.e. rails, pickets, and posts) shall be warranted within specified limitations, by the manufacturer for a period of 20 years from date of original purchase. Warranty shall cover any defects in material finish, including cracking, peeling, chipping, blistering or corroding.

B. Reimbursement for labor necessary to restore or replace components that have been found to be defective under the terms of manufactures warranty shall be guaranteed for five (5) years from date of original purchase.

PART 2 - MATERIALS

2.01 MANUFACTURER

The fence system shall conform to (specify Montage Plus standard picket space or Montage Plus Pool, Pet & Play 3" air space) **Welded and Rackable** (ATF – All Terrain Flexibility) Ornamental Steel, (for standard picket space, specify Classic, Majestic, Genesis or Warrior; for 3" air space, specify Classic, Majestic, or Genesis) design, (specify extended picket or flush) bottom rail treatment, (specify 2-Rail, 3-Rail or 3-Rail with Double Rings) style manufactured by Ameristar Fence Products, Inc., in Tulsa, Oklahoma.

2.02 MATERIAL

A. Steel material for fence panels and posts shall conform to the requirements of ASTM A653/A653M, with a minimum yield strength of 45,000 psi (310 MPa) and a minimum zinc (hot-dip galvanized) coating weight of 0.60 oz/ft² (184 g/m²), Coating Designation G-60.

B. Material for pickets shall be 3/4" square x 18 Ga. tubing. The rails shall be steel channel, 1.5" x 1.4375" x 14 Ga. Picket holes in the rail shall be spaced (specify 4.675" o.c. for standard picket space or 3.500" o.c. for 3" air space). Fence posts and gate posts shall meet the minimum size requirements of Table 1.

2.03 FABRICATION

A. Pickets, rails and posts shall be pre-cut to specified lengths. Rails shall be pre-punched to accept pickets.

B. Pickets shall be inserted into the pre-punched holes in the rails and shall be aligned to standard spacing using a specially calibrated alignment fixture. The aligned pickets and rails shall be joined at each picket-to-rail intersection by Ameristar's proprietary fusion welding process, thus completing the rigid panel assembly (Note: The process produces a virtually seamless, spatter-free good-neighbor appearance, equally attractive from either side of the panel).

C. The manufactured panels and posts shall be subjected to an inline electrode position coating (E-Coat) process consisting of a multi-stage pretreatment/wash, followed by a duplex application of an epoxy primer and an acrylic topcoat. The minimum cumulative coating thickness of epoxy and acrylic shall be 2 mils (0.058 mm). The color shall be Black. The coated panels and posts shall be capable of meeting the performance requirements for each quality characteristic shown in Table 2 (Note: The requirements in Table 2 meet or exceed the coating performance criteria of ASTM F2408).

D. The manufactured fence system shall be capable of meeting the vertical load, horizontal load, and infill performance requirements for Commercial weight fences under ASTM F2408.

E. Classic, Majestic, Genesis & Warrior styles with 3 & 4-rail configurations shall meet IBC compliance. Panel, post and bracket assemblies shall be subjected to structural performance testing according to Chapter 17 – Structural Tests and Special Inspections – International Building Code (IBC) 2018. Physical testing to be completed by accredited third party testing facility. Completed assembly shall demonstrate loading capacity of 2.5 times prescribed design loads found in section 1607.8.1, 1607.8.1.1 and 1607.8.1.2 of IBC 2018 for Handrails and Guards. IBC compliant fence system requirements detailed within Table 4.

F. Gates with an out-to-out leaf dimension less than and including 72 inches shall be fabricated using Montage Plus ornamental panel material and 1-3/4" sq. x 14ga. gate ends. Gate leafs greater than 72 inches shall be fabricated using ForeRunner rails, 17 gauge pickets, intermediate uprights, gussets and 1-3/4" sq. x 14ga. gate ends. All rail and upright intersections shall be joined by welding. All picket and rail intersections shall also be joined by welding.

PART 3 - EXECUTION

3.01 PREPARATION

All new installation shall be laid out by the contractor in accordance with the construction plans.

3.02 INSTALLATION

Fence post shall be spaced according to Table 3, plus or minus ¼". For installations that must be raked to follow sloping grades, the post spacing dimension must be measured along the grade. Fence panels shall be attached to posts with brackets supplied by the manufacturer. Posts shall be set in concrete footers having a minimum depth of 36" (Note: In some cases, local restrictions of freezing weather conditions may require a greater depth). The "Earthwork" and "Concrete" sections of this specification shall govern material requirements for the concrete footer. Posts setting by other methods such as plated posts or grouted core-drilled footers are permissible only if shown by engineering analysis to be sufficient in strength for the intended application.

3.03 FENCE INSTALLATION MAINTENANCE

When cutting/drilling rails or posts adhere to the following steps to seal the exposed steel surfaces; 1) Remove all metal shavings from cut area. 2) Apply zinc-rich primer to thoroughly cover cut edge and/or drilled hole; let dry. 3) Apply 2 coats of custom finish paint matching fence color. Failure to seal exposed surfaces per steps 1-3 above will negate warranty. Ameristar spray cans or paint pens shall be used to prime and finish exposed surfaces; it is recommended that paint pens be used to prevent overspray. Use of non-Ameristar parts or components will negate the manufactures' warranty.

3.04 GATE INSTALLATION

Gate posts shall be spaced according to the manufacturers' gate drawings, dependent on standard out-to-out gate leaf dimensions and gate hardware selected. Type and quantity of gate hinges shall be based on the application; weight, height, and number of gate cycles. The manufacturers' gate drawings shall identify the necessary gate hardware required for the application. Gate hardware shall be provided by the manufacture of the gate and shall be installed per manufacturer's recommendations.

3.05 CLEANING

The contractor shall clean the jobsite of excess materials; post-hole excavations shall be scattered uniformly away from posts.

Table 1 – Minimum Sizes for Montage Plus Posts		
<u>Fence Posts</u>	<u>Panel Height</u>	
2-1/2" x 16 Ga.	Up to & Including 6' Height	
<u>Gate Leaf</u>	<u>Gate Height</u>	
	<u>Up to & Including 4'</u>	<u>Over 4' Up to & Including 6'</u>
Up to 4'	2-1/2" x 16 Ga.	2-1/2" x 14 Ga.
4'1" to 6'	3" x 12 Ga.	3" x 12 Ga.
6'1" to 10'	4" x 11 Ga.	4" x 11 Ga.
10'1" to 16'	6" x 3/16" wall	6" x 3/16" wall

Table 2 – Coating Performance Requirements		
<u>Quality Characteristics</u>	<u>ASTM Test Method</u>	<u>Performance Requirements</u>
Adhesion	D3359 – Method B	Adhesion (Retention of Coating) over 90% of test area (Tape and knife test).
Corrosion Resistance	B117, D714 & D1654	Corrosion Resistance over 1,500 hours (Scribed per D1654; failure mode is accumulation of 1/8" coating loss from scribe or medium #8 blisters).
Impact Resistance	D2794	Impact Resistance over 60-inch lb. (Forward impact using 0.625" ball).
Weathering Resistance	D822 D2244, D523 (60° Method)	Weathering Resistance over 1,000 hours (Failure mode is 60% loss of gloss or color variance of more than 3 delta-E color units).

Table 3 – Montage Plus – Post Spacing By Bracket Type	
Span	For CLASSIC, GENESIS, MAJESTIC, & WARRIOR 8' Nominal (91.95" Rail)

Post Size	2-1/2"	2-1/2"	2-1/2"	3"	2-1/2"	3"
Bracket Type	Montage Plus Universal (BB112)	Montage Plus Line Blvd. (BB114)	Montage Plus Flat Mount (BB111)		Montage Plus Swivel (BB113)*	
Post Settings ± 1/4" O.C.	95"	95"	95"	95-1/2"	*95"	*95-1/2"
*Note: When using BB113 swivel brackets on either or both ends of a panel installation, care must be taken to ensure the spacing between post and adjoining pickets meets applicable codes. This will require trimming one or both ends of the panel.						

Table 4 – Montage Plus – IBC Compliant System Requirements				
Panel Options		Post Options		Brackets Options
Styles	Rail Configuration	Steel Post Options	Post Plate Options (anchorage by others)	Line Boulevard Brackets
Classic	3-Rail & 4-Rail	2.5" SQ x 14ga	8" x 8" x 3/8" – for 2.5" posts 10" x 10" x 3/8" – for 3" posts	End Boulevard Brackets
Majestic		3" SQ x 12ga		Corner Boulevard Brackets
Genesis		4" SQ x 12ga		*Flat Mount Brackets
Warrior				*Note: Flat Mount Brackets require a thru-bolt installation
Panel, post, and bracket assemblies shall be subjected to structural performance testing according to Chapter 17 - Structural Tests and Special Inspections - International Building Code (IBC) 2018. Physical testing to be completed by accredited third party testing facility. Completed assembly shall demonstrate loading capacity of 2.5 times prescribed design loads found in section 1607.8.1, 1607.8.1.1 and 1607.8.1.2 of IBC 2018 for Handrails and Guards.				

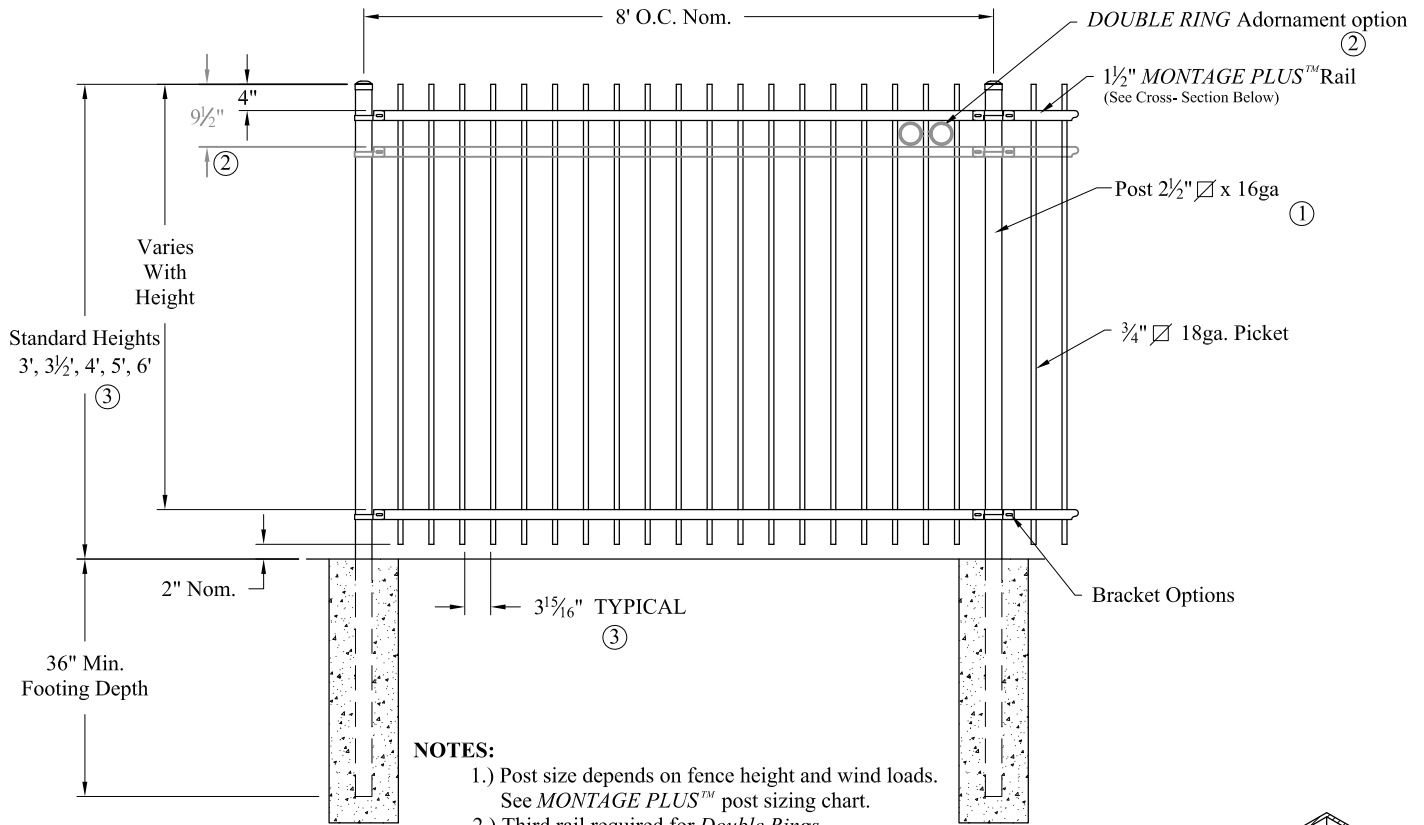

NOTES:

- 1.) Post size depends on fence height and wind loads. See MONTAGE PLUS™ post sizing chart.
- 2.) Third rail required for Double Rings.
- 3.) Available in 3" air space and/or Flush Bottom on most heights.

RAKING DIRECTIONAL ARROW

Welded panel can be raked 30" over 8' with arrow pointing down grade.

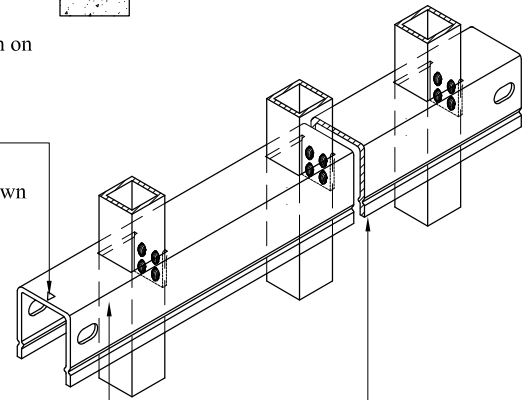

PROFUSION™ WELDING PROCESS

No exposed welds,
Good Neighbor profile - Same appearance on both sides

MONTAGE PLUS™ RAIL
Specially formed high strength architectural shape.

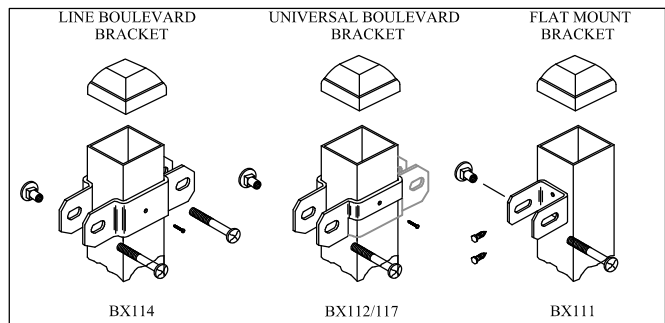
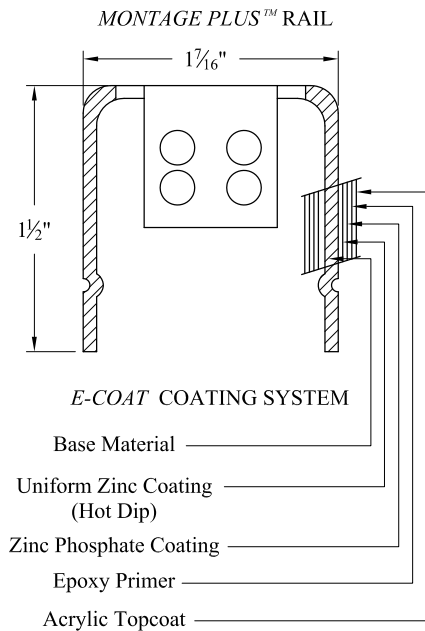

COMMERCIAL STRENGTH WELDED STEEL PANEL
PRE-ASSEMBLED

Values shown are nominal and not to be used for installation purposes. See product specification for installation requirements.

IRGISO

Title: MONTAGE PLUS GENESIS 2/3-RAIL			
DR: CI	SH . 1 of 1	SCALE: DO NOT SCALE	
CK: ME	Date 6/28/10	REV: e	



AMERISTAR®

1555 N. Mingo
Tulsa, OK 74116
1-888-333-3422
www.ameristarfence.com